



21-29 Pikkat Drive Braemar NSW

49 🚗

Carlton Real Estate is excited to present this state of the art storage/logistics facility located in 'Highlands Business Park' offering brand new industrial units at the gateway to the Southern Highlands.

Noted as the prime commercial corridor of the Southern Highlands and surrounded by major retail businesses such as Flip Out, EQ Saddlery, ARB, Bunnings Warehouse and Irelands Machinery, the development is well positioned within the heart of this buzzing commercial precinct and boasts direct 24hr B-double access (north and south).

- State of the art storage/logistics facility offering premium warehouse and office space.
- Multiple tenancies available from 1,169sqm - 1,208sqm

Type : Industrial
Price : Contact Agent
Building Size : 1169 sqm
Land Size : 7630 sqm
View : <https://www.carltonrealestate.com.au/lease/nsw/southern-highlands/braemar/commercial/industrial/7979948>



Emma-Jane Carswell
 0414 958 060

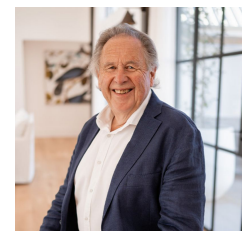

Arvo Pikkat
 02 4874 2622

[For full version visit the website](https://www.carltonrealestate.com.au)

<https://www.carltonrealestate.com.au>

We are one of the longest running, award-winning real estate agencies in the Southern Highlands.

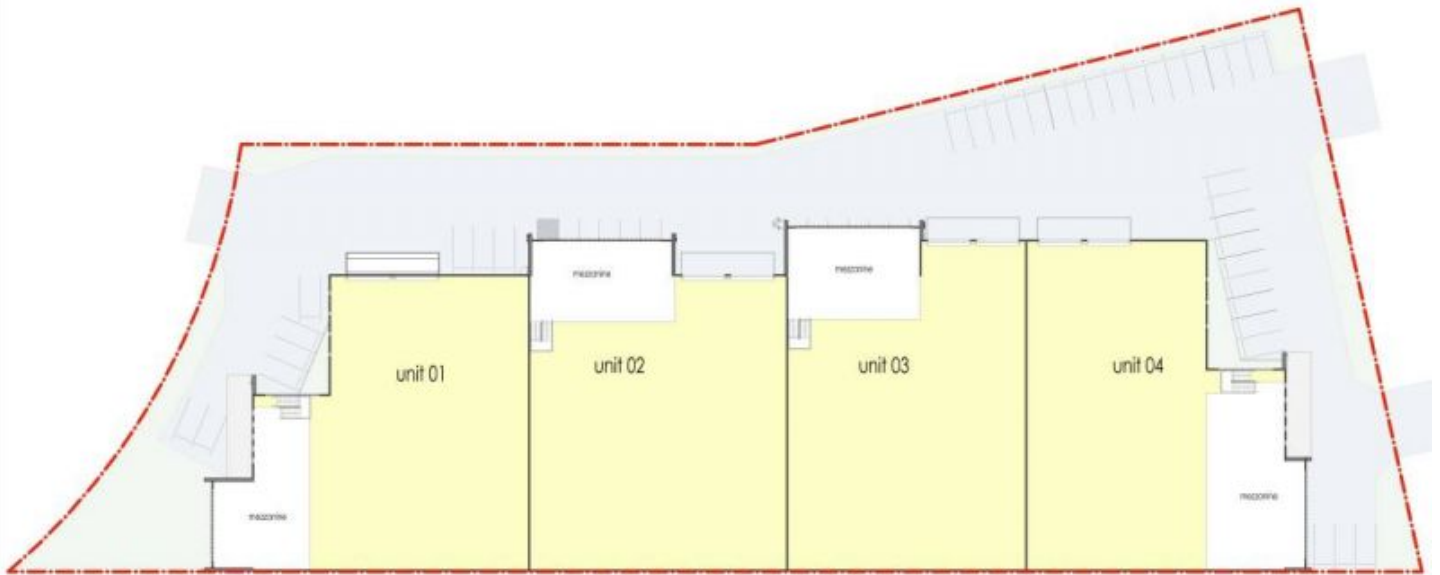

1 mezzanine level
1:200

| Rev. | Modificazioni | Aut. | Verifica | Descrizione |
|------|---------------|------|----------|-------------|
| 1 | 01 | 01 | 01 | 01 |
| 2 | 02 | 02 | 02 | 02 |
| 3 | 03 | 03 | 03 | 03 |
| 4 | 04 | 04 | 04 | 04 |
| 5 | 05 | 05 | 05 | 05 |
| 6 | 06 | 06 | 06 | 06 |



progettazione architettonica e urbanistica
via ...
tel. ...
www.bdaa.it

ARDESIGN
via ...
tel. ...
www.ar-design.it



PROGETTO: ...
AUTORE: ...
DATA: ...
SCALA: ...
Foglio: 1030