



### 2/3 Gantry Place Braemar NSW

Located in the true centre of the Industrial precinct yet is only minutes from the Freeway. This strategic location will give your business a head-start on the competition!

- ? Boutique complex of 7
- ? Available areas from 270sqm to 370sqm
- ? Dedicated truck turning areas
- ? Minimum Internal clearance of 7 metres
- ? 5 metre roller doors
- ? 3 phase power
- ? Secure gated complex
- ? Easy access to freeway and M5
- ? Strategically located in the true heart of Mittagong's industrial area.

Priced from \$3,000 per month plus GST and outgoings.

**Building Size** : 270 sqm  
**Land Size** : 4050 sqm  
**View** : <https://www.carltonrealestate.com.au/lease/nsw/southern-highlands/braemar/commercial/industrial/7518728>



**Emma-Jane Carswell**  
**02 4871 2622**

<https://www.carltonrealestate.com.au>

We are one of the longest running, award-winning real estate agencies in the Southern Highlands.

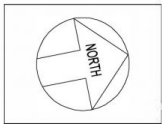
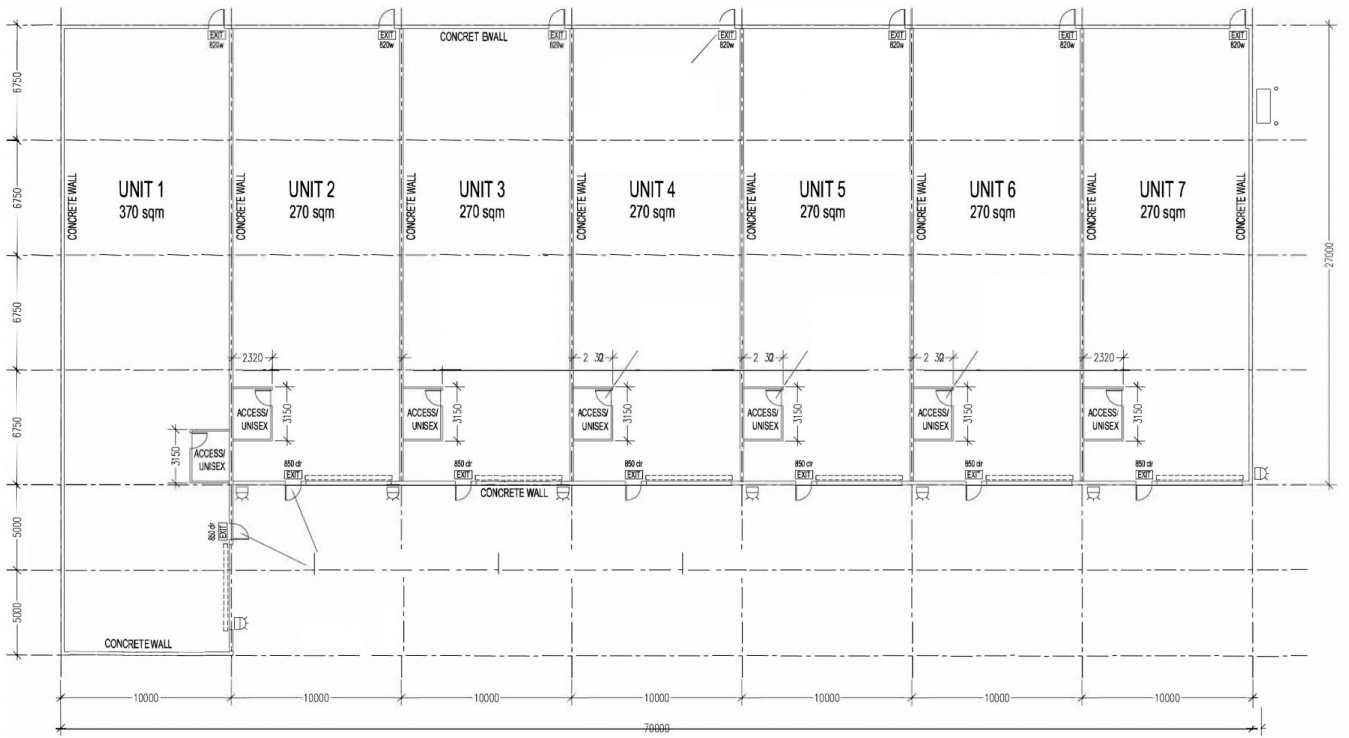

EST 1982  
**CARLTON**  
 REAL ESTATE