



4/3 Gantry Place Braemar NSW

Located in the true centre of the Industrial precinct yet is only minutes from the Freeway. This strategic location will give your business a head-start on the competition!

- ? Boutique complex of 7
- ? Available areas from 270sqm to 370sqm
- ? Dedicated truck turning areas
- ? Minimum Internal clearance of 7 metres
- ? 5 metre roller doors
- ? 3 phase power
- ? Secure gated complex
- ? Easy access to freeway and M5
- ? Strategically located in the true heart of Mittagong's industrial area.

Priced from \$3,000 per month plus GST and outgoings.

Building Size : 270 sqm
Land Size : 4050 sqm
View : <https://www.carltonrealestate.com.au/lease/nsw/southern-highlands/braemar/commercial/industrial/7505431>



Emma-Jane Carswell
02 4871 2622

<https://www.carltonrealestate.com.au>

We are one of the longest running, award-winning real estate agencies in the Southern Highlands.

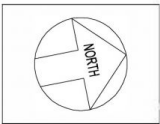
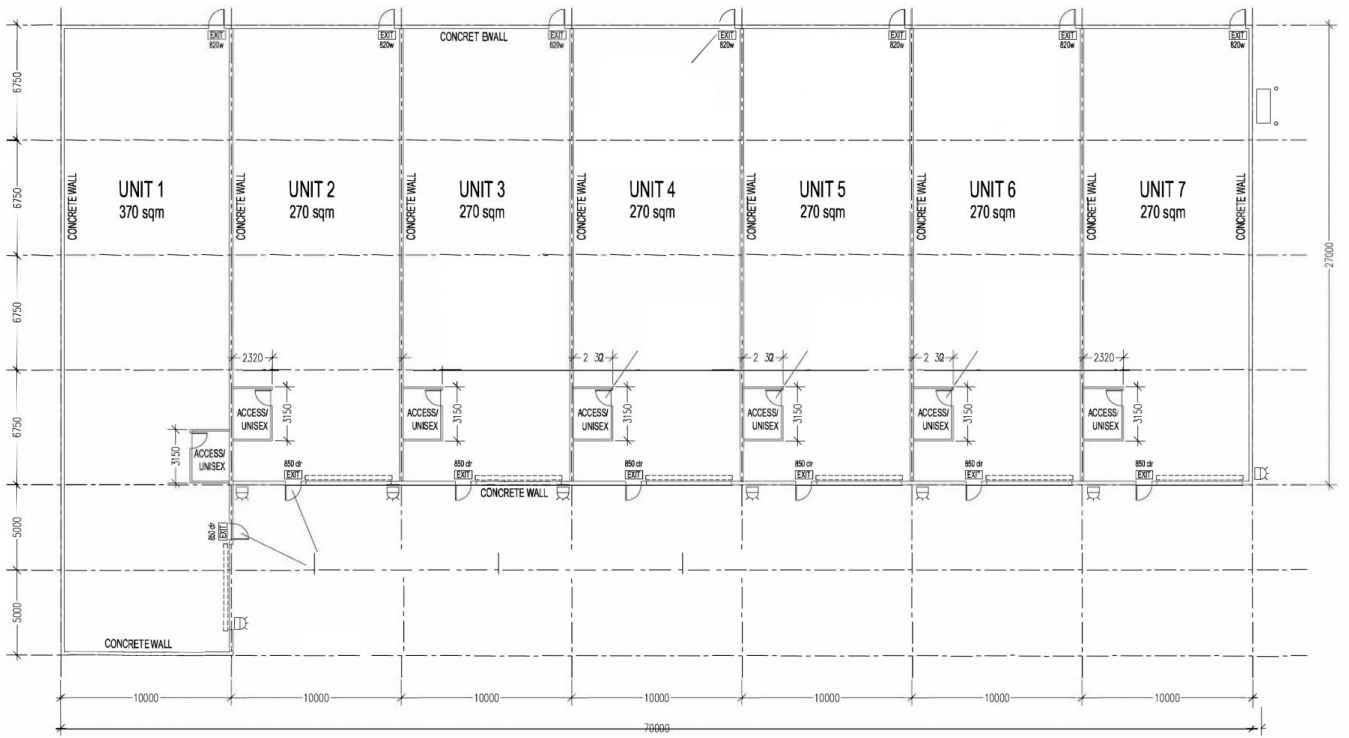

EST 1982
CARLTON
 REAL ESTATE