



20 Old Hume Highway Yerrinbool NSW

4 3

Nestled on the fringes of the Southern Highlands, this large charming brick home is a superb first home opportunity or investment proposition. Surrounded by charming established gardens, this property boasts a relaxed and generous layout whilst cleverly utilising its 873 sqm level corner block occupation.

- ? Master bedroom with walk in wardrobe, ample extra inbuilt storage nook and ensuite.
- ? Large living areas with slow combustion fireplace and reverse cycle.
- ? Separate children's wing with walk in wardrobe and ensuite.
- ? Main two-way bathroom with desirable separate toilet.
- ? Large kitchen with modern appliances, live in ready or add your own renovated touches.
- ? Ample storage with linen cupboards throughout the

Price : \$ 750,000
Building Size : 165 sqm
Land Size : 873 sqm
View : <https://www.carltonrealestate.com.au/sale/nsw/southern-highlands/yerrinbool/residential/house/7177042>



Mark Walters
02 4871 2622

<https://www.carltonrealestate.com.au>

We are one of the longest running, award-winning real estate agencies in the Southern Highlands.



SITE PLAN (NOT TO SCALE)

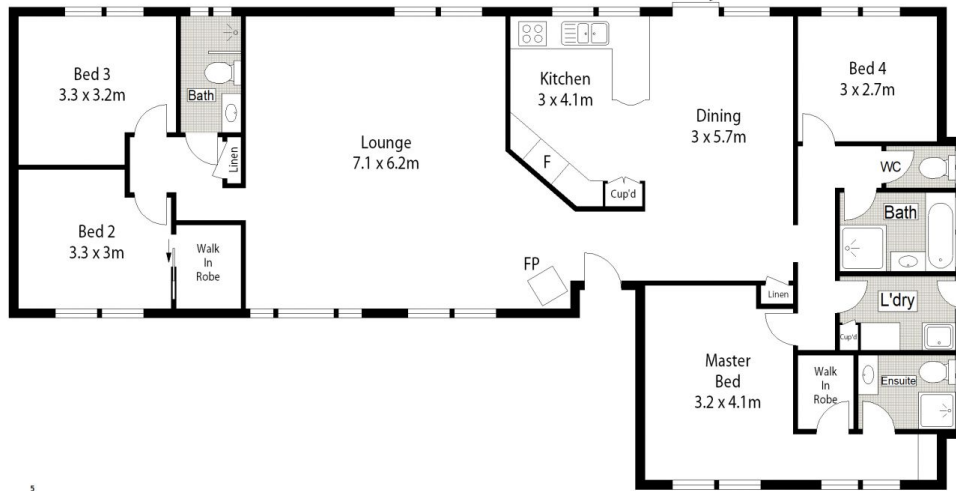

0 1 2 3 4 5
SCALE (METRES)



20 Old Hume Highway, Yerrinbool

EST 1982
CARLTON
REAL ESTATE