



**110 Old Hume Hwy Yerrinbool NSW**

4 🛏 3 🚿 1 🚗

Nestled in the warm embrace of a private tranquil garden paradise, this unique home impresses with high vaulted ceilings, exposed beams and spacious rooms.

Features include:

- Large master bedroom with luxurious ensuite featuring a spa bath with bi-fold cedar windows opening up to the private garden oasis.
- Spacious 2nd bedroom also with ensuite and robe.
- 2 more bedrooms, 1 with robe.
- Main bathroom with shower and bath.
- Open plan kitchen, family and dining room.
- Separate lounge room with cedar doors opening up to the rear veranda.
- Cosy slow combustion heater and reverse cycle split air-conditioning.
- 5-kilowatt solar system.

**Land Size** : 1160 sqm

**View** : <https://www.carltonrealestate.com.au/lease/nsw/southern-highlands/yerrinbool/residential/house/6860787>



**Lee Astill**  
02 4872 5555



**Rhiannon Hurst**  
02 4872 5555

<https://www.carltonrealestate.com.au>

We are one of the longest running, award-winning real estate agencies in the Southern Highlands.

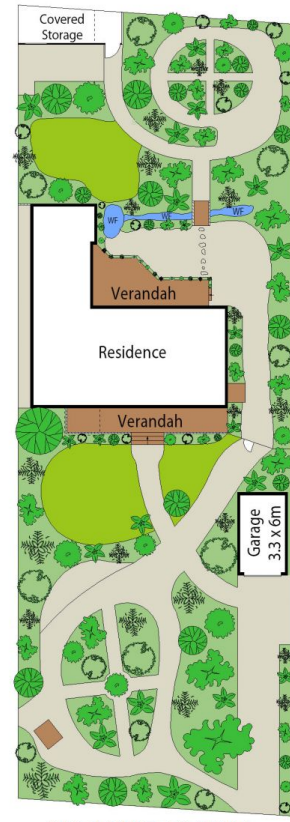

SITE PLAN (NOT TO SCALE)



0 1 2 3 4 5 SCALE (METRES)

Scale in metres. Indicative only. Dimensions are approximate. All information contained herein is gathered from sources we believe to be reliable. However we cannot guarantee its accuracy and interested persons should rely on their own enquiries.

110 Old Hume Highway, Yerrinbool

EST 1982  
**CARLTON**  
 REAL ESTATE