



EST 1982
CARLTON
REAL ESTATE

Campbelltown - 55km
Sydney CBD - 105km
Canberra - 192km

Mittagong - 5km
Bowral - 9.6km

Direct 24hrs access to
Hume Highway

Prime greenfield
industrial precinct
with IN1 zoning.

Fully serviced lots
with NBN, power,
sewer & water

Prelease & lot
sale opportunities
available

CONTACT Arvo Pikkat 02 4871 2622 048 334 328 *Agent's Interest
CARLTONREALESTATE.COM.AU



Lot 9/12 Lady Tyree Place Braemar NSW

- SOUTHERN HIGHLANDS GATEWAY SITE
- LOTS RANGING FROM 1540 TO 5900sqm
- FULLY SERVICED & FLEXIBLE SETTLEMENT

Land Size : 2240 sqm
View : <https://www.carltonrealestate.com.au/sale/nsw/southern-highlands/braemar/commercial/development/5864117>

A rare opportunity to invest or develop within this highly sort after and strategically positioned business park. This premium estate is zoned IN1 and can facilitate a multitude of flexible land uses.

The precinct is quickly evolving into the prime commercial corridor of the Southern Highlands. Surrounded by major retail land uses such as Bunnings Warehouse and Irelands Machinery, the estate is well positioned within the heart of this buzzing commercial precinct. Boasting direct 24hr access (north and south) to the Hume Highway, future purchasers can expect a 25-30 minute reduction in travel time to Sydney's CBD when compared to the Shire's



Arvo Pikkat
02 4871 2622



Simon Pikkat
02 4871 2622

<https://www.carltonrealestate.com.au>

We are one of the longest running, award-winning real estate agencies in the Southern Highlands.

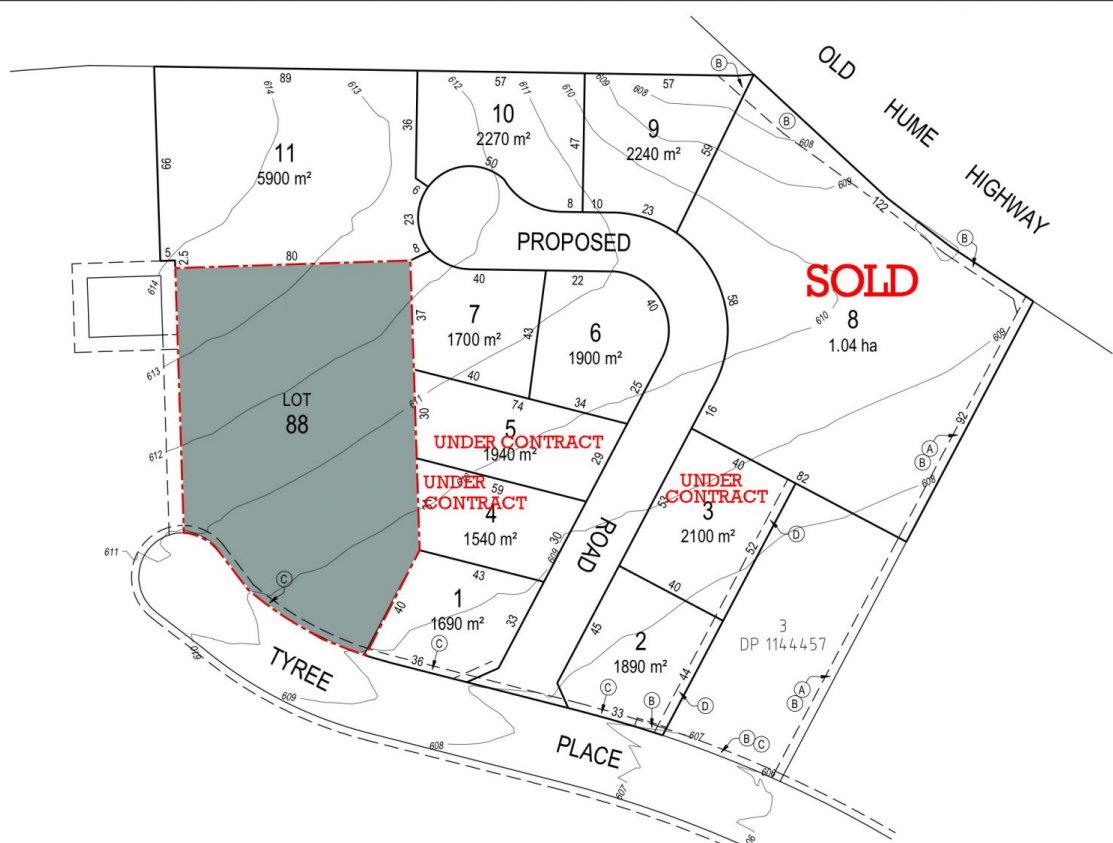

EST 1982
CARLTON
 REAL ESTATE

Tyree Business Park - Plan of Subdivision

Prepared by: Simon Pikkat

01.10.19