



**EST 1982**  
**CARLTON**  
REAL ESTATE

**INDUSTRIAL LAND FOR SALE**

**TYREE BUSINESS PARK**

- Prime industrial land located at the gateway to the Southern Highlands
- Direct 24hr access North and South to the Hume Highway connecting Sydney and Melbourne
- Lots ranging from 1640m<sup>2</sup> to 5900m<sup>2</sup> with flexible fit zoning
- Fully serviced lots with NBN, power, sewer and water
- Flexible settlement options

CONTACT Arvo Pikkat 02 4871 2622 0418 284 528 \*Agents Interest CARLTONREALESTATE.COM.AU



**Lot 11/16 Lady Tyree Place Braemar NSW**

- SOUTHERN HIGHLANDS GATEWAY SITE
- LOTS RANGING FROM 1540 TO 5900sqm
- FULLY SERVICED & FLEXIBLE SETTLEMENT

**Land Size** : 5900 sqm  
**View** : <https://www.carltonrealestate.com.au/sale/nsw/southern-highlands/braemar/commercial/development/5864115>

A rare opportunity to invest or develop within this highly sort after and strategically positioned business park. This premium estate is zoned IN1 and can facilitate a multitude of flexible land uses.

The precinct is quickly evolving into the prime commercial corridor of the Southern Highlands. Surrounded by major retail land uses such as Bunnings Warehouse and Irelands Machinery, the estate is well positioned within the heart of this buzzing commercial precinct. Boasting direct 24hr access (north and south) to the Hume Highway, future purchasers can expect a 25-30 minute reduction in travel time to Sydney's CBD when compared to the Shire's



**Arvo Pikkat**  
**02 4871 2622**



**Simon Pikkat**  
**02 4871 2622**

<https://www.carltonrealestate.com.au>

We are one of the longest running, award-winning real estate agencies in the Southern Highlands.

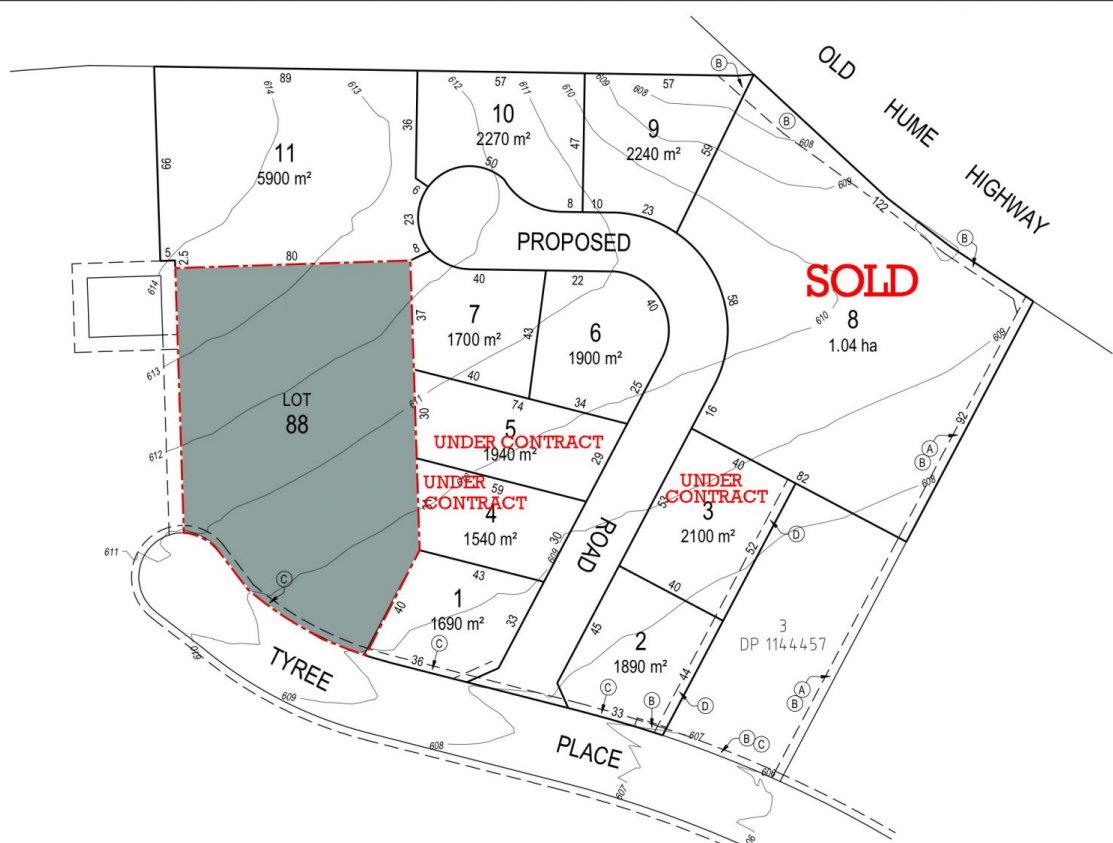

EST 1982  
**CARLTON**  
 REAL ESTATE

Tyree Business Park - Plan of Subdivision

Prepared by: Simon Pikkat

01.10.19