



EST 1982
CARLTON
REAL ESTATE

- Campbelltown - 55km
Sydney CBD - 105km
Canberra - 192km
- Mittagong - 5km
Bowral - 9.6km
- Direct 24hrs access to Hume Highway
- Prime greenfield industrial precinct with IN1 zoning.
- Fully serviced lots with NBN, power, sewer & water
- Prelease & lot sale opportunities available



EST 1982
CARLTON
REAL ESTATE

INDUSTRIAL LAND FOR SALE

TYREE BUSINESS PARK

- Prime industrial land located at the gateway to the Southern Highlands
- Direct 24hr access North and South to the Hume Highway connecting Sydney and Melbourne
- Lots ranging from 1540sqm to 5900sqm with flexible fit zoning
- Fully serviced lots with NBN, power, sewer and water
- Flexible settlement options

CONTACT Arvo Pikkat 02 4871 2622 0419 254 326 *Agents Interest CARLTONREALESTATE.COM.AU

Lot 5/5 Lady Tyree Place Mittagong NSW

- SOUTHERN HIGHLANDS GATEWAY SITE
- LOTS RANGING FROM 1540 TO 5900sqm
- FULLY SERVICED & FLEXIBLE SETTLEMENT

A rare opportunity to invest or develop within this highly sort after and strategically positioned business park. This premium estate is zoned IN1 and can facilitate a multitude of flexible land uses.

The precinct is quickly evolving into the prime commercial corridor of the Southern Highlands. Surrounded by major retail land uses such as Bunnings Warehouse and Irelands Machinery, the estate is well positioned within the heart of this buzzing commercial precinct. Boasting direct 24hr access (north and south) to the Hume Highway, future purchasers can expect a 25-30 minute reduction in travel time to Sydney's CBD when compared to the Shire's

Price : \$ 832,260
Land Size : 1940 sqm
View : <https://www.carltonrealestate.com.au/sale/nsw/southern-highlands/mittagong/commercial/development/5815026>



Arvo Pikkat
02 4871 2622



Simon Pikkat
02 4871 2622

<https://www.carltonrealestate.com.au>

We are one of the longest running, award-winning real estate agencies in the Southern Highlands.

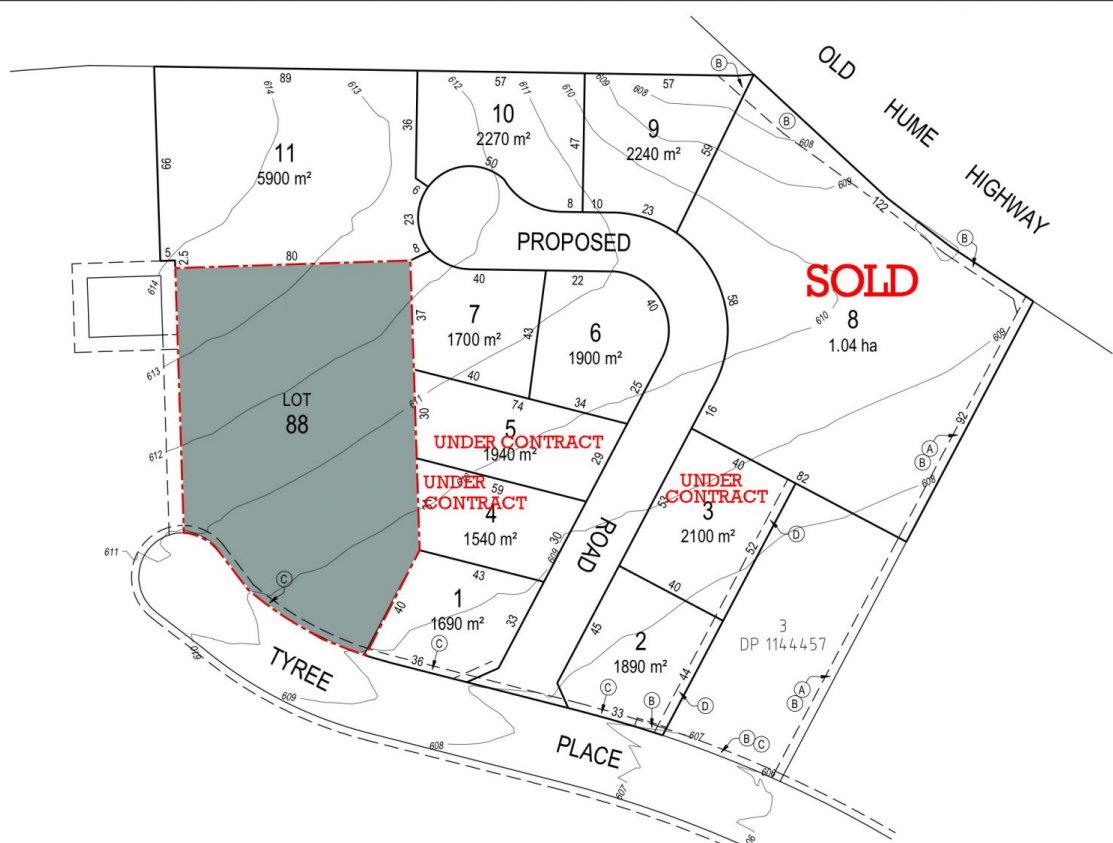

EST 1982
CARLTON
 REAL ESTATE

Tyree Business Park - Plan of Subdivision	
Prepared by: Simon Pikkat	
01.10.19	