



EST 1982
CARLTON
REAL ESTATE COMMERCIAL

INDUSTRIAL LAND FOR SALE

TYREE BUSINESS PARK

- Prime industrial land located at the gateway to the Southern Highlands.
- Direct 24hr access North and South to the Hume Highway connecting Sydney and Melbourne.
- Lot 4 ranging from 1540m² to 5900m² with flexible FSI zoning.
- Fully serviced lots with NBN, power, sewer and water.
- Flexible settlement options.

CONTACT Arvo Pikkat 02 4871 2622 0418 284 328 *Agent's Interest CARLTONREALESTATE.COM.AU



Lot 4/3 Lady Tyree Place Braemar NSW

- SOUTHERN HIGHLANDS GATEWAY SITE
- LOTS RANGING FROM 1540 TO 5900sqm
- FULLY SERVICED & FLEXIBLE SETTLEMENT

Land Size : 1540 sqm
View : <https://www.carltonrealestate.com.au/sale/nsw/southern-highlands/braemar/commercial/development/5814908>

A rare opportunity to invest or develop within this highly sort after and strategically positioned business park. This premium estate is zoned IN1 and can facilitate a multitude of flexible land uses.

The precinct is quickly evolving into the prime commercial corridor of the Southern Highlands. Surrounded by major retail land uses such as Bunnings Warehouse and Irelands Machinery, the estate is well positioned within the heart of this buzzing commercial precinct. Boasting direct 24hr access (north and south) to the Hume Highway, future purchasers can expect a 25-30 minute reduction in travel time to Sydney's CBD when compared to the Shire's



Arvo Pikkat
02 4871 2622



Simon Pikkat
02 4871 2622

<https://www.carltonrealestate.com.au>

We are one of the longest running, award-winning real estate agencies in the Southern Highlands.

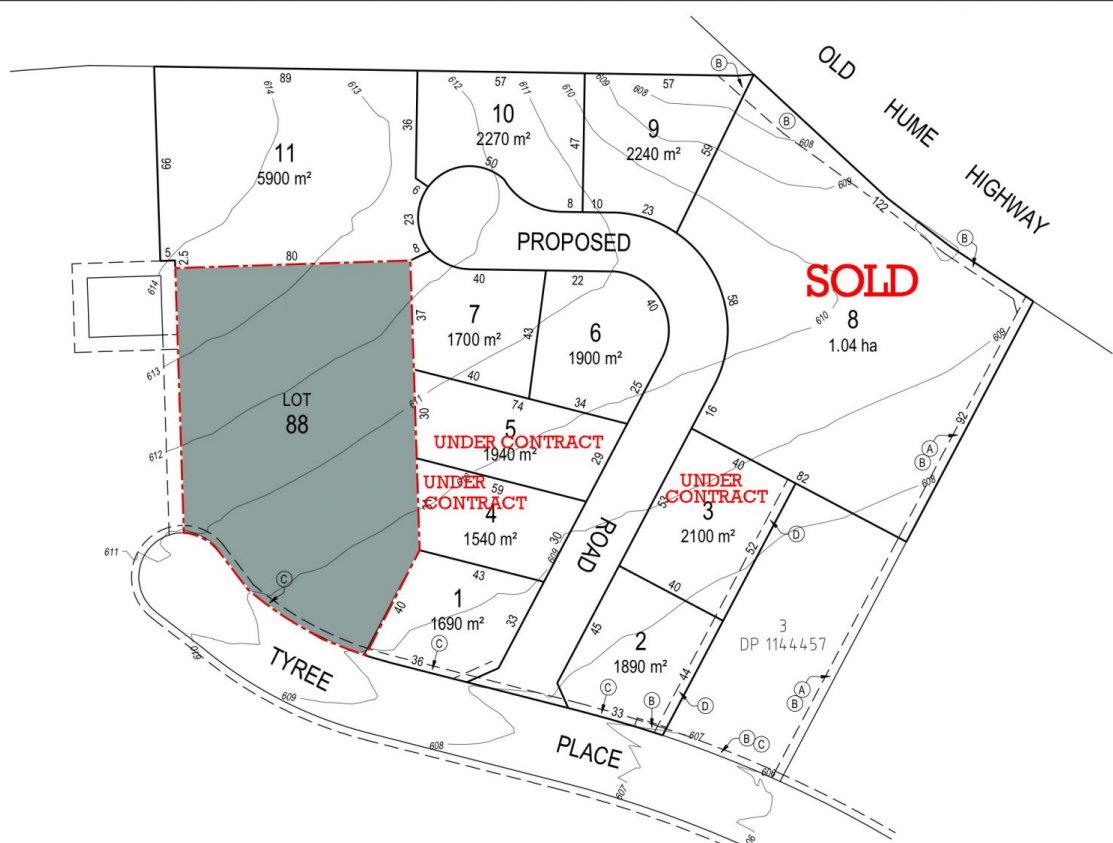

EST 1982
CARLTON
 REAL ESTATE

Tyree Business Park - Plan of Subdivision
 Prepared by: Simon Pikkat
 01.10.19