

EST 1982

CARLTON

REAL ESTATE

 Campbelltown - 55km Sydney CBD - 105km Canberra - 192km	 Mittagong - 5km Bowral - 9.6km
 Direct 24hrs access to Hume Highway	 Prime greenfield industrial precinct with IN1 zoning.
 Fully serviced lots with NBN, power, sewer & water	 Pre-lease & lot sale opportunities available



Lot 88/12 Tyree Place Braemar NSW

Carlton Real Estate is pleased to offer Lot 88, 10 Tyree Place Braemar for sale by way of Expressions of Interest (EOI).

The lot is 9,155sqm and has a Development Approval for an ultra-modern and architecturally designed warehousing facility with offices comprising 5,465sqm of floor space and 56 car parking spaces. The approved floor plate is highly flexible and could easily be adapted to a suit single user or multiple tenancies.

The precinct is quickly evolving into the prime commercial corridor of the Southern Highlands. Surrounded by major retail land uses such as Bunnings Warehouse and Irelands Machinery, the site is well positioned within the heart of this buzzing commercial precinct. Boasting direct 24hr access (north and south) to the Hume Highway, future purchasers

Building Size : 5465 sqm
Land Size : 9155 sqm
View : <https://www.carltonrealestate.com.au/sale/nsw/southern-highlands/braemar/commercial/development/5813207>



Arvo Pikkat
02 4871 2622



Simon Pikkat
02 4871 2622

<https://www.carltonrealestate.com.au>

We are one of the longest running, award-winning real estate agencies in the Southern Highlands.

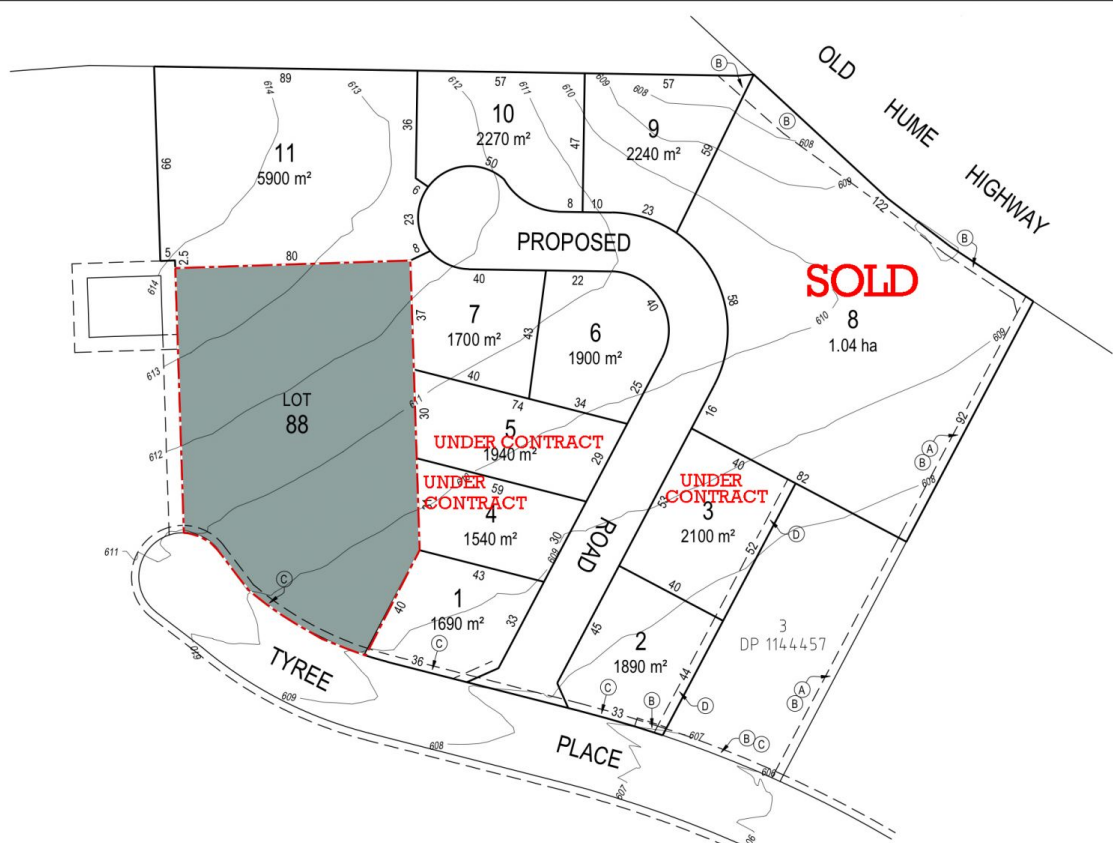

EST 1982
CARLTON
 REAL ESTATE

Tyree Business Park - Plan of Subdivision	
Prepared by: Simon Pikkat	
01.10.19	